

DFK-MC 1,5/15-GF-3,81

Order No.: 1829468

The figure shows a 10-position version of the product

<http://eshop.phoenixcontact.de/phoenix/treeViewClick.do?UID=1829468>

Plug component, Nominal current: 8 A, Rated voltage (III/2): 160 V,
Number of positions: 15, Pitch: 3.81 mm, Color: green, Metal surface:
Sn, Assembly: Direct mounting

Commercial data

| | |
|--------------------------|--|
| GTIN (EAN) |  4 017918 051143 |
| sales group | E102 |
| Pack | 50 pcs. |
| Customs tariff | 85366990 |
| Catalog page information | Page 188 (CC-2009) |

Product notes

WEEE/RoHS-compliant since:
01/01/2003



<http://www.download.phoenixcontact.com>
Please note that the data given here has been taken from the online catalog. For comprehensive information and data, please refer to the user documentation. The General Terms and Conditions of Use apply to Internet downloads.

Technical data

Dimensions / positions

| | |
|---------------------|----------|
| Pitch | 3.81 mm |
| Dimension a | 53.34 mm |
| Number of positions | 15 |

Technical data

| | |
|------------------------------------|---------------------|
| Range of articles | DFK-MC 1,5/..-GF |
| Insulating material group | I |
| Rated surge voltage (III/3) | 2.5 kV |
| Rated surge voltage (III/2) | 2.5 kV |
| Rated surge voltage (II/2) | 2.5 kV |
| Rated voltage (III/2) | 160 V |
| Rated voltage (II/2) | 320 V |
| Connection in acc. with standard | EN-VDE |
| Nominal current I_N | 8 A |
| Nominal voltage U_N | 160 V |
| Nominal cross section | 1.5 mm ² |
| Maximum load current | 8 A |
| Insulating material | PA |
| Inflammability class acc. to UL 94 | V0 |
| Max. current slip-on connection | 8 A |
| Dimensions of slip-on connection | 2,8 x 0,8 mm |

Connection data

| | |
|--|----------------------|
| Conductor cross section solid min. | 0.14 mm ² |
| Conductor cross section solid max. | 1.5 mm ² |
| Conductor cross section stranded min. | 0.14 mm ² |
| Conductor cross section stranded max. | 1.5 mm ² |
| Conductor cross section AWG/kcmil min. | 28 |
| Conductor cross section AWG/kcmil max | 16 |

Certificates / Approvals



Certification

CB, CSA, CUL, GOST, UL, VDE-PZI

Accessories

| Item | Designation | Description |
|-----------------|-------------|---|
| Assembly | | |
| 0710015 | DFK-MC SS | Screw set, for securing the header to the housing wall, consists of M2 x 8 screw, spring washer and nut, 1 piece each |

| Marking | | |
|----------------|--------------------------|--|
| 0804109 | SK 3,81/2,8:FORTL.ZAHLEN | Marker card, printed horizontally, self-adhesive, 10-section marker strip, 14 identical decades marked 1-10, 11-20 etc. up to 91-(99)100, sufficient for 140 terminal blocks |

| Plug/Adapter | | |
|---------------------|---------|---|
| 1734634 | CP-MSTB | Keying profile, is inserted into the slot on the plug or inverted header, red insulating material |

| Tools | | |
|--------------|-----------------|---|
| 1205037 | SZS 0,4X2,5 VDE | Screwdriver, bladed, VDE insulated, size: 0.4 x 2.5 x 80 mm, 2-component grip, with non-slip grip |

Additional products

| Item | Designation | Description |
|----------------|--------------------------|---|
| General | | |
| 1851368 | FK-MCP 1,5/15-STF-3,81 | Plug component, Nominal current: 8 A, Rated voltage (III/2): 160 V, Number of positions: 15, Pitch: 3.81 mm, Color: green, Metal surface: Sn |
| 1850987 | FRONT-MC 1,5/15-STF-3,81 | Plug component, Nominal current: 8 A, Rated voltage (III/2): 160 V, Number of positions: 15, Pitch: 3.81 mm, Color: green, Metal surface: Sn |
| 1827839 | MC 1,5/15-STF-3,81 | Plug component, Nominal current: 8 A, Rated voltage (III/2): 160 V, Number of positions: 15, Pitch: 3.81 mm, Color: green, Metal surface: Sn |
| 1852493 | MCC 1/15-STZF-3,81 | Plug component, Nominal current: 8 A, Rated voltage (III/2): 160 V, Number of positions: 15, Pitch: 3.81 mm, Color: green, Metal surface: Sn, Corresponding female crimp contacts with current [A] and conductor cross section range [mm ²] data: 5A/MCC-MT 0,2-0,35 (1859988); 8A/MCC-MT 0,5-1,0 (1859991) |
| 1828472 | MCVR 1,5/15-STF-3,81 | Plug component, Nominal current: 8 A, Rated voltage (III/2): 160 V, Number of positions: 15, Pitch: 3.81 mm, Color: green, Metal surface: Sn |
| 1828621 | MCVW 1,5/15-STF-3,81 | Plug component, Nominal current: 8 A, Rated voltage (III/2): 160 V, Number of positions: 15, Pitch: 3.81 mm, Color: green, Metal surface: Sn |

| | | |
|---------|--------------------|--|
| 1897678 | QC 0,5/15-STF-3,81 | Plug component, Nominal current: 6 A, Rated voltage (III/2): 200 V, Number of positions: 15, Pitch: 3.81 mm, Color: green, Metal surface: Sn |
|---------|--------------------|--|

Diagrams/Drawings

Drilling plan/solder pad geometry

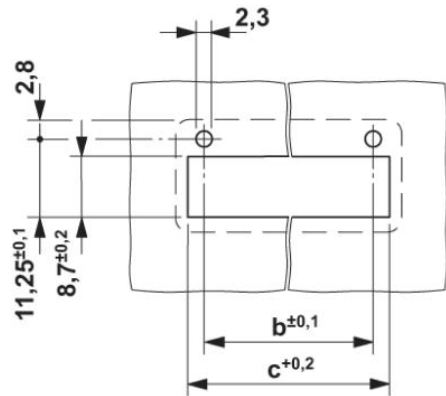

Dimension b = 6.19 mm + (no. of pos. x 3.81 mm)
 Dimension c = Dim. b + 4.7 mm

Dimensioned drawing

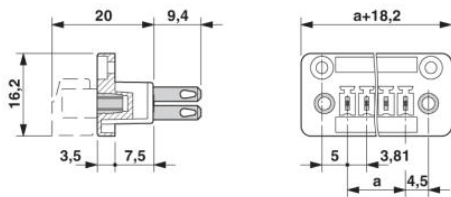

Address

PHOENIX CONTACT Deutschland GmbH
Flachmarktstr. 8
32825 Blomberg, Germany
Phone +49 5235 3 12000
Fax +49 5235 3 41200
<http://www.phoenixcontact.de>



© 2010 Phoenix Contact
Technical modifications reserved;